

# 424

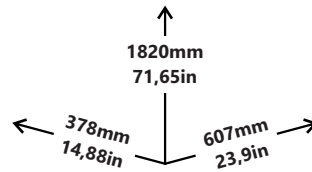

### ACCESORIOS / ACCESSORIES / ACESSÓRIOS / ACCESSOIRES

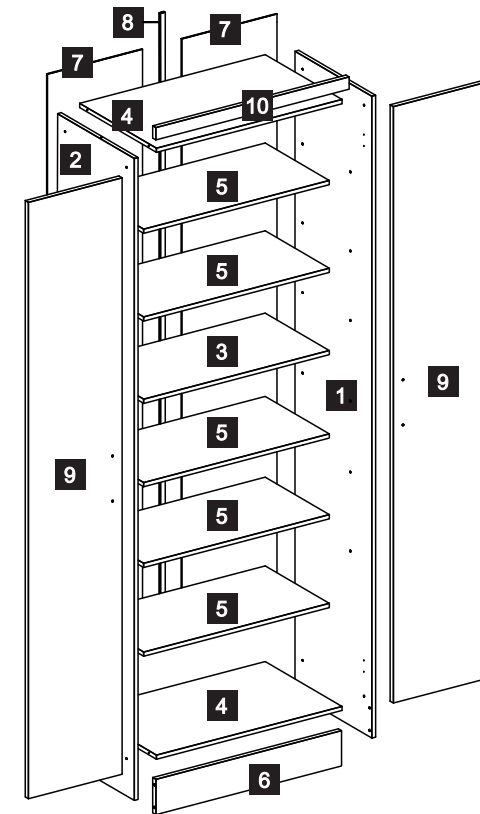
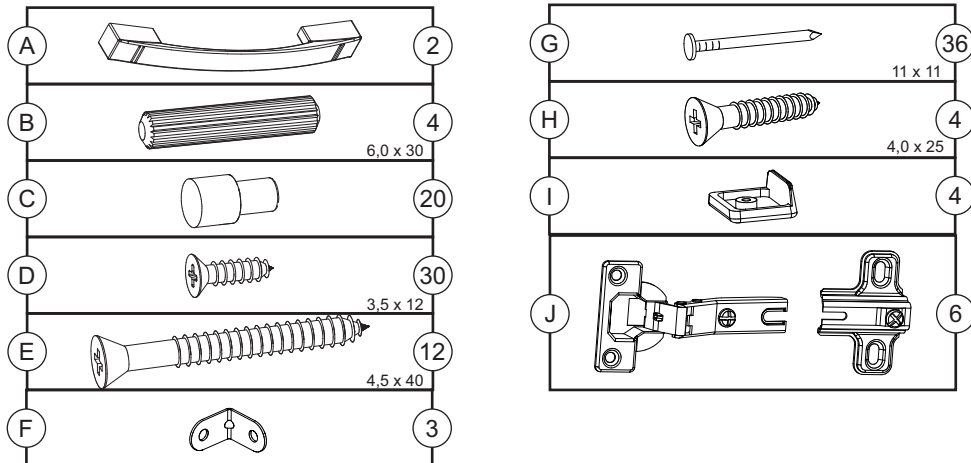

### LISTA DE PEÇAS / PARTS LIST / LISTA DE PEÇAS / LISTE DES PIÈCES

#	Ct Qt	Piezas	Pieces	Peças	Pièces	
1	1	Lateral Derecha	Right Side Panel	Lateral Direita	Côté Droit	1820 x 360 x 12
2	1	Lateral Izquierda	Left Side Panel	Lateral Esquerda	Côté Gauche	1820 x 360 x 12
3	1	Repisa Fija	Fixed Shelf	Prateleira Fixa	Étagère Fixe	583 x 300 x 12
4	2	Base/Tampo	Base/Top	Base/Tampo	Fond/Pièce du Dessus	583 x 360 x 12
5	5	Repisa Móvil	Movable Shelf	Prateleira Móvel	Étagère Mobile	583 x 300 x 12
6	1	Zócalo	Baseboard	Rodapé	Socle	583 x 100 x 15
7	2	Costado	Back Panel	Costa	Pièce Arrière	1700 x 299 x 3
8	1	Perfil	Profile	Perfil	Profil	1658mm
9	2	Puerta	Door	Porta	Porte	1691 x 294 x 15
10	1	Marco	Frame	Moldura	Cadre	607 x 35 x 15

HERRAMIENTAS  
 HARDWARE  
 FERRAMENTAS  
 OUTILS

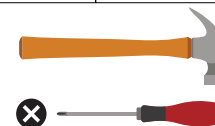

PERSONAS NECESARIAS PARA EL MONTAJE  
 PEOPLE REQUIRED FOR ASSEMBLY  
 PESSOAS NECESSÁRIAS PARA A MONTAGEM  
 NOMBRE DE PERSONNES NÉCESSAIRES  
 À L'ASSEMBLAGE



### **Consejos de Conservación**

1. No debe utilizarse en la limpieza, abrasivos como lana de acero, alcohol, limón, o productos corrosivos que puedan rayar o quitar la película en los muebles.
2. Cuando la limpieza de muebles en general, napa y formica, deben utilizarse un paño ligeramente humedecido y jabón suave.
3. Para mover el mueble, es importante que este se eleve desde el suelo, debido a que el arrastre puede causar daño estructural.
4. No deje el mueble en exposición a la intemperie.

### **Conservation Tips**

1. Do not use abrasive products to clean such as steel wool, alcohol, vinegar, lemon, scouring powder, or corrosive products which can scratch or peel off the protective film of the furniture.
2. The best way to clean your furniture is to use a slightly moistened cloth with a mild soap.
3. To move the furniture assembled, it is important that it is lifted off the ground, because the drag it can cause structural damage.
4. Do not leave your furniture in weather exposure.

### **Dicas de conservação**

1. Não utilizar na limpeza produtos abrasivos tais como: palha de aço, álcool, vinagre, limão, saponáceo ou produtos corrosivos que possam riscar ou descolar a película protetora dos móveis.
2. Na limpeza de móveis em geral, napa e fórmicas, deve ser utilizado um pano levemente umedecido e sabão neutro.
3. Para a movimentação do móvel, é importante que este seja levantado do chão, pois ao arrastá-lo pode causar avarias estruturais.
4. Não deixe o móvel em exposição a intempéries.

### **Conseils d'entretien**

1. Ne pas utiliser de produits abrasifs dans le nettoyage, tels que: laine d'acier, alcool, vinaigre, citron, poudre à récurer ou autres produits corrosifs pouvant rayer ou faire décoller la pellicule protectrice des meubles.
2. Pour le nettoyage du meuble, il est recommandé d'utiliser un chiffon humide et du savon neutre.
3. Pour déplacer le meuble, il est important de le soulever du sol car le tirer pourrait causer des dommages dans sa structure.
4. Ne pas exposer le meuble aux intempéries.

### **CERTIFICADO DE GARANTIA (SOMENTE BRASIL)**

**A garantia dos produtos fabricados pela Carraro, abrange eventuais defeitos/vícios de fabricação, no prazo estabelecido pelo Código de Defesa do Consumidor, em seu artigo 26,II, o qual prevê a garantia legal de 90 (noventa) dias.**

### **PESO POR TAPA**

Por favor, preste atención a los pesos máximos admitidos por cada compartimiento del producto.

Tenga cuidado de no exceder estos pesos, con el fin de garantizar la calidad y durabilidad del producto. Es importante recordar que los pesos muestran en caso de ser DISTRIBUIDA en toda el área de la plataforma.

### **WEIGHT PER TOP**















Please pay attention to the maximum weights supported by each compartment product. Be careful not to exceed these weights, in order to ensure the quality and durability of the product. It is important to remember also that the weights shown should be DISTRIBUTED throughout the area of the shelf.

### **PESO POR TAMPO**

Por favor, preste atenção aos pesos máximos suportados por cada compartimento do produto. Cuide para não exceder esses pesos, afim de garantir a qualidade e a durabilidade do mesmo. É importante lembrar também que, os pesos mostrados devem ser DISTRIBUÍDOS ao longo de toda a área da peça.

### **POIDS PAR TOP**

Veillez faire attention aux poids maximums supportés par chaque produit du compartiment. Veillez à ne pas dépasser ces poids, afin de garantir la qualité et la durabilité du produit. Il est également important de se rappeler que les poids indiqués doivent être RÉPARTIS sur toute la surface du rayon.

1

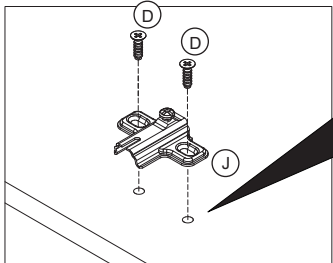
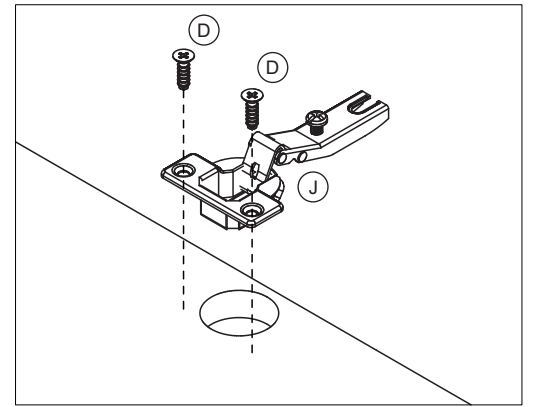
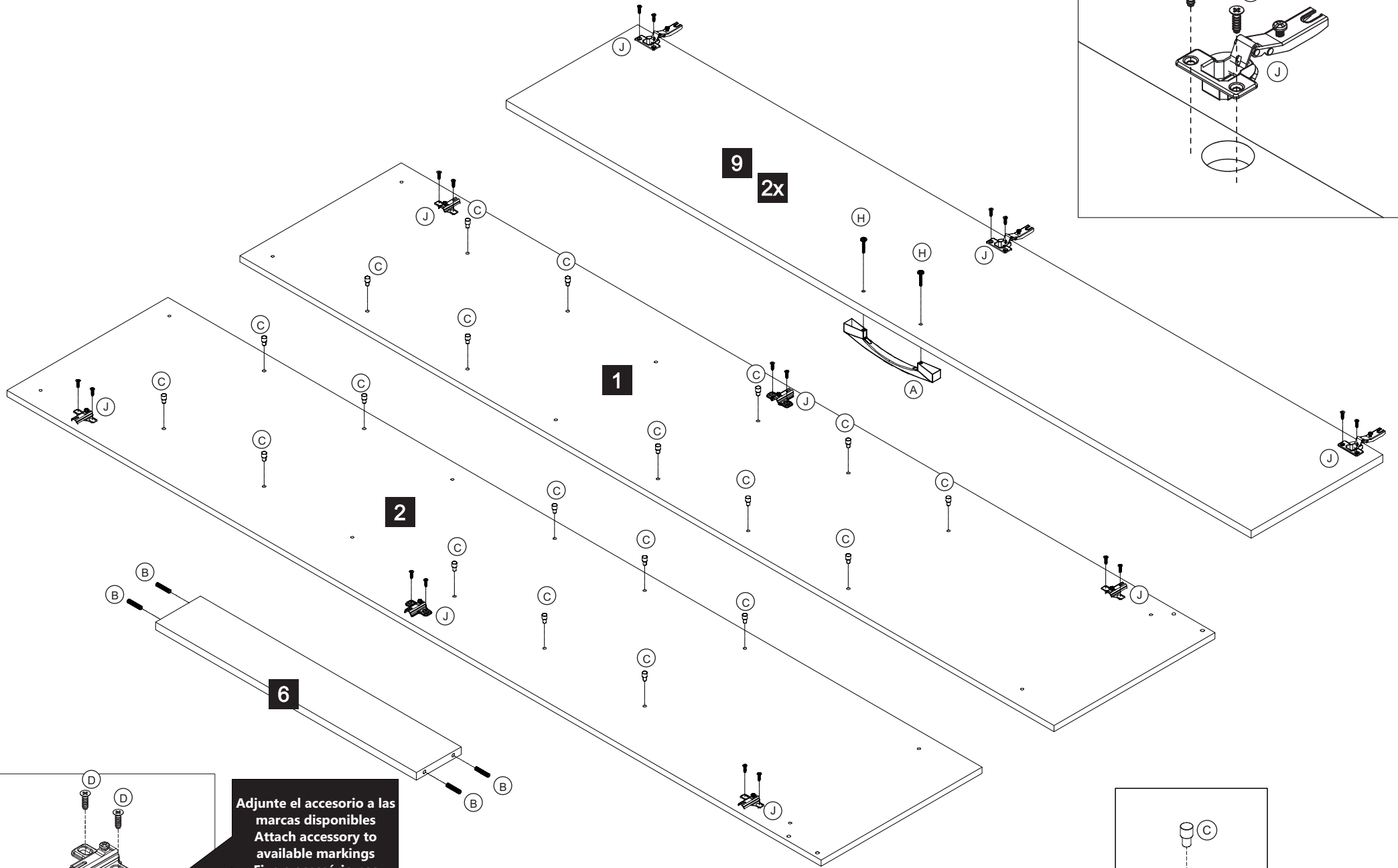

Adjunte el accesorio a las  
 marcas disponibles  
 Attach accessory to  
 available markings  
 Fixe o acessório nas  
 marcações disponíveis  
 Attacher l'accessoire à la  
 marquages disponibles

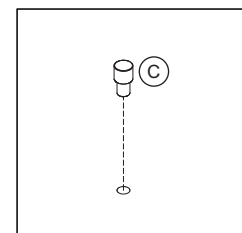

2

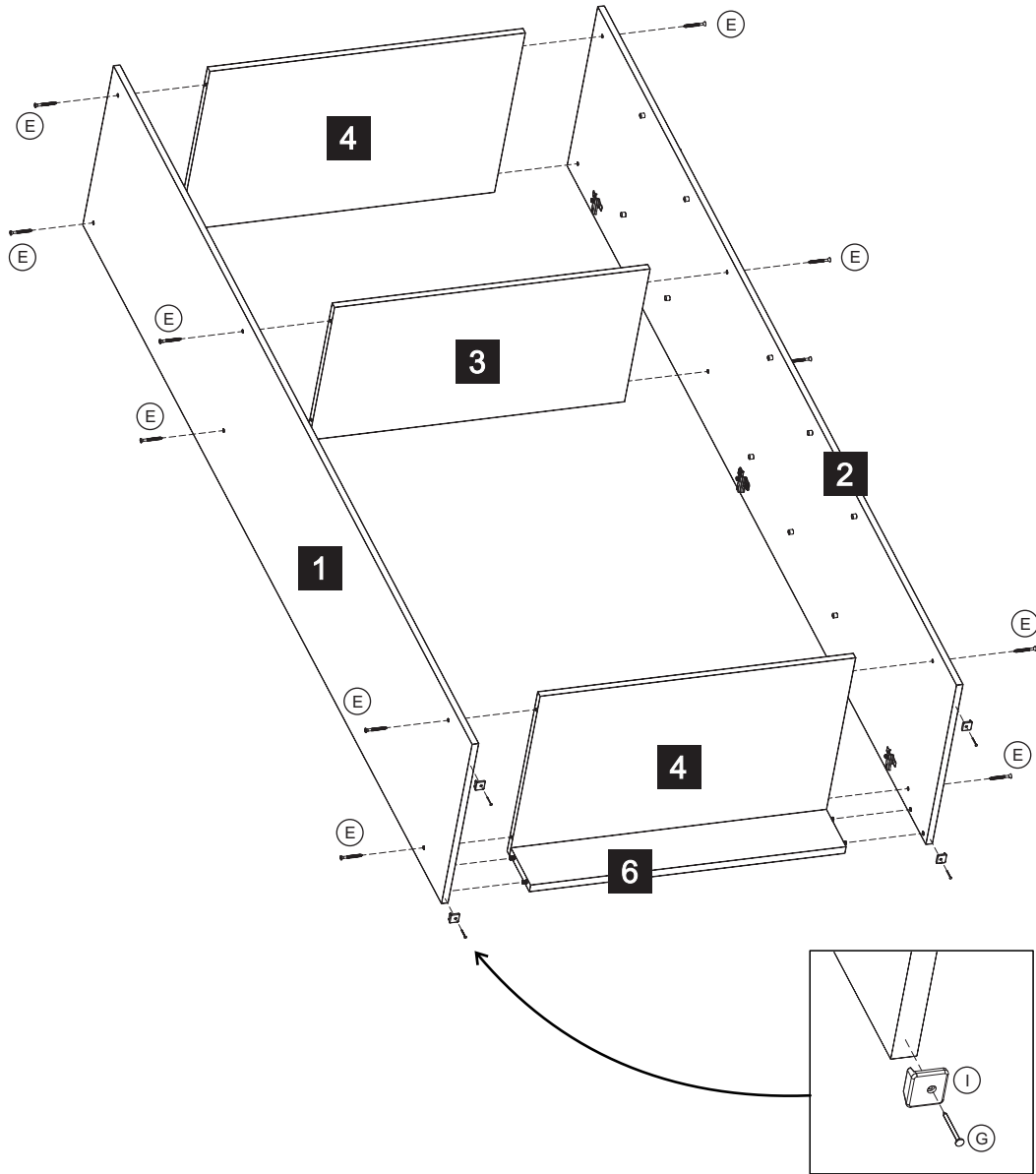

3

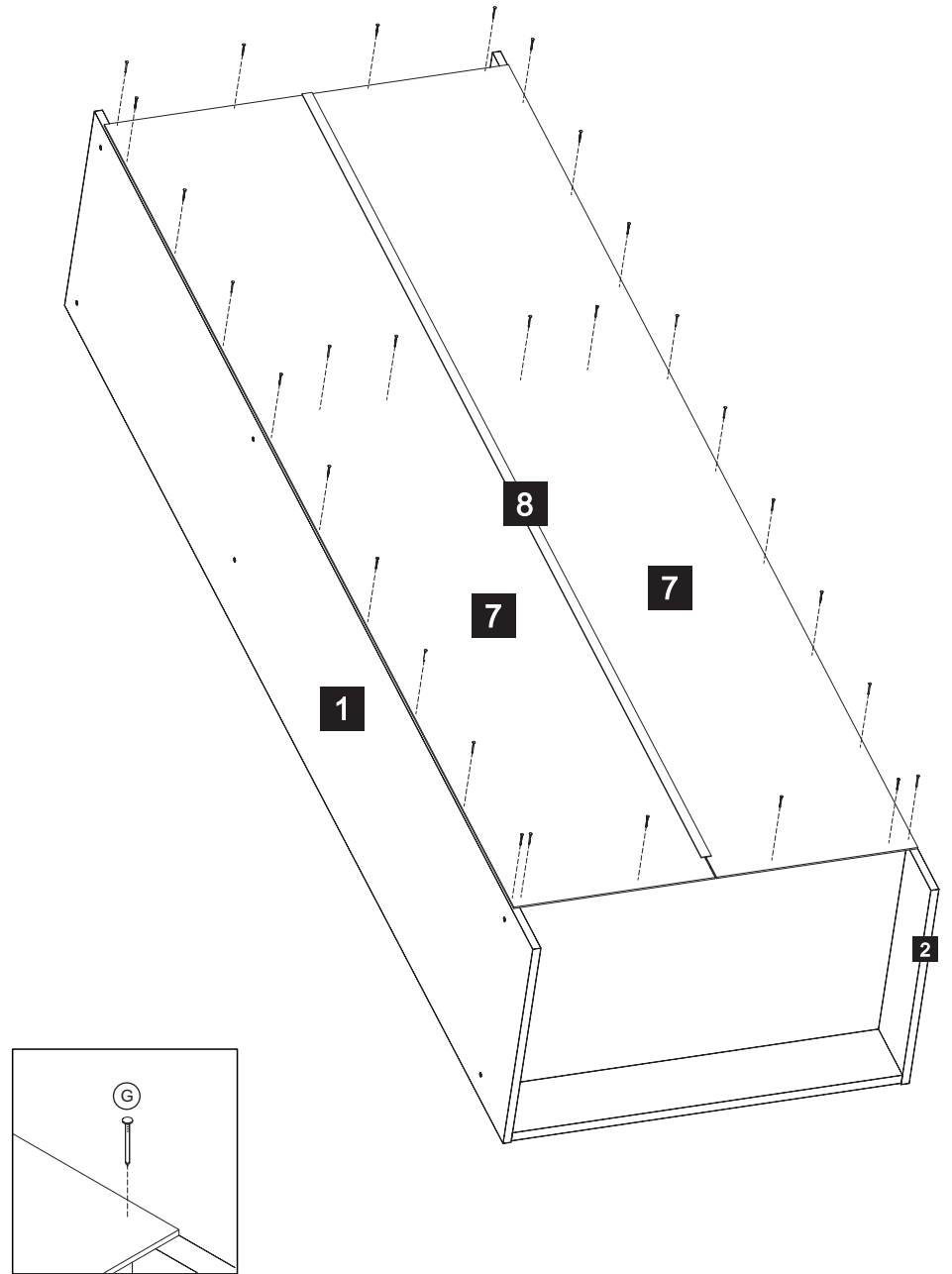

4

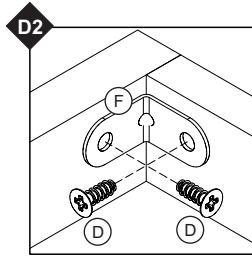
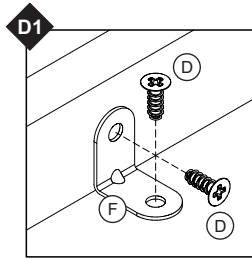
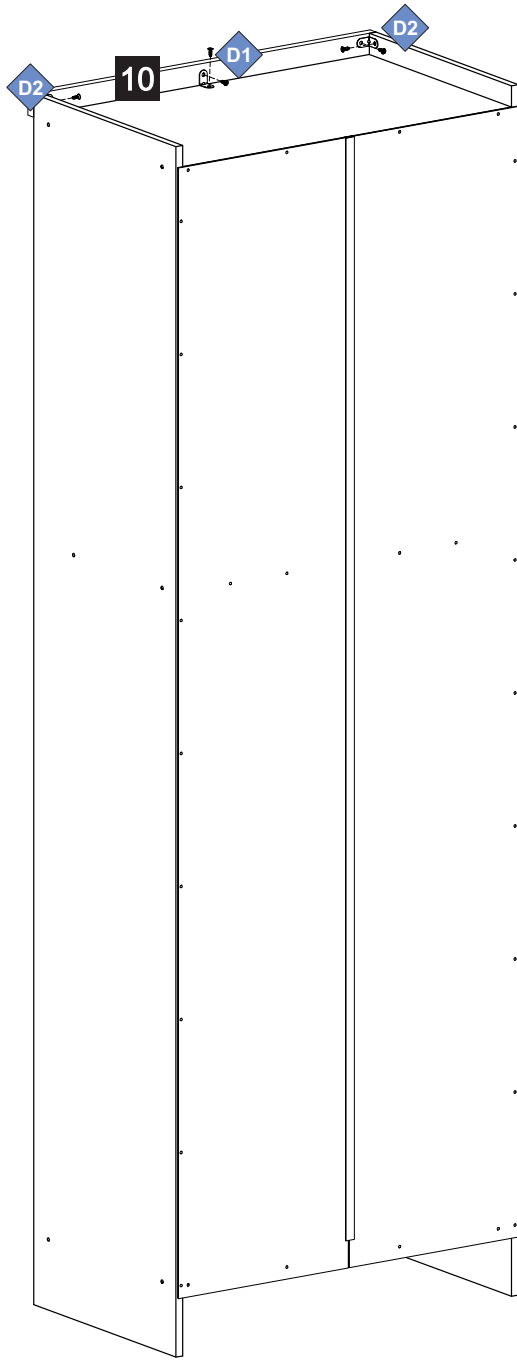

5

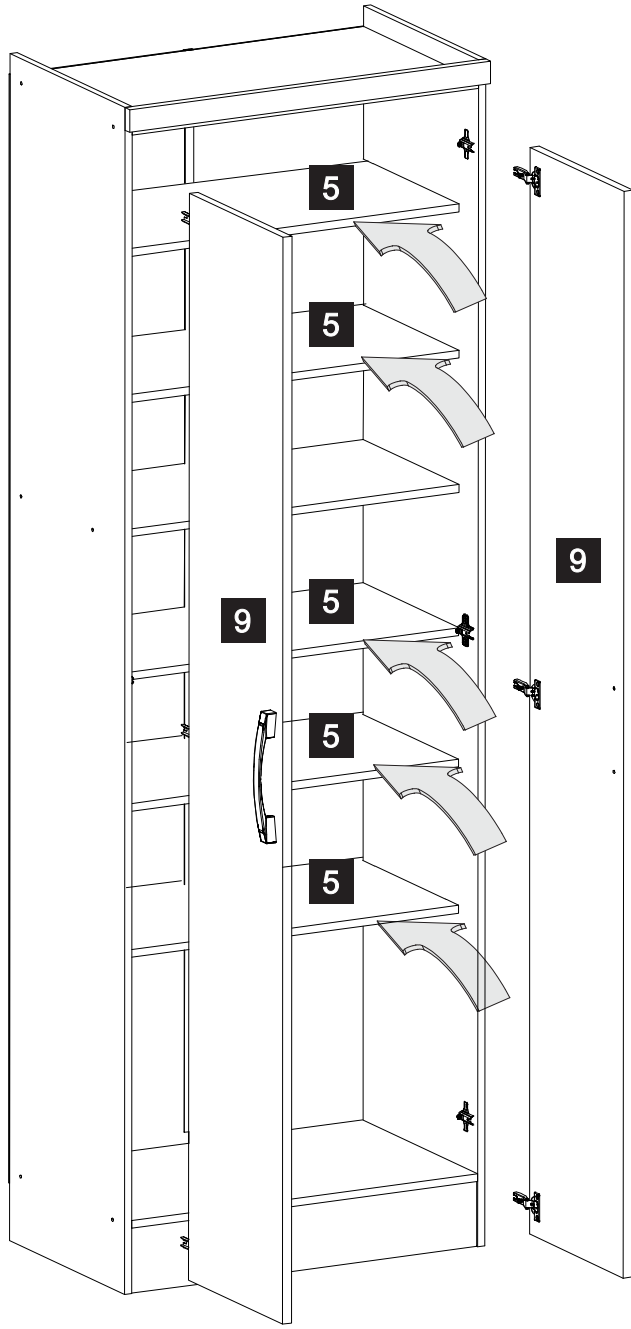

**Ajuste da Porta / Door Adjustment / Ajuste de la Puerta / Réglage des charnières de la porte**

Encaixe da porta  
Door setting  
Encaje de la puerta  
Logement de porte

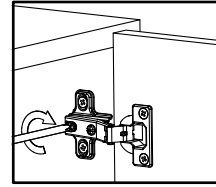

Ajuste de Altura  
Height Adjustment  
Ajuste del Alto  
Réglage en Hauteur

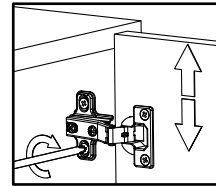

Ajuste Interno  
Internal Adjustment  
Ajuste Interno  
Réglage Latéral

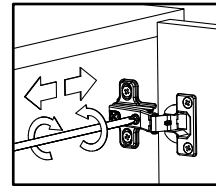

Ajuste de Profundidade  
Depth Adjustment  
Ajuste de la Profundidad  
Réglage en Profondeur

